

## User Instruction Document

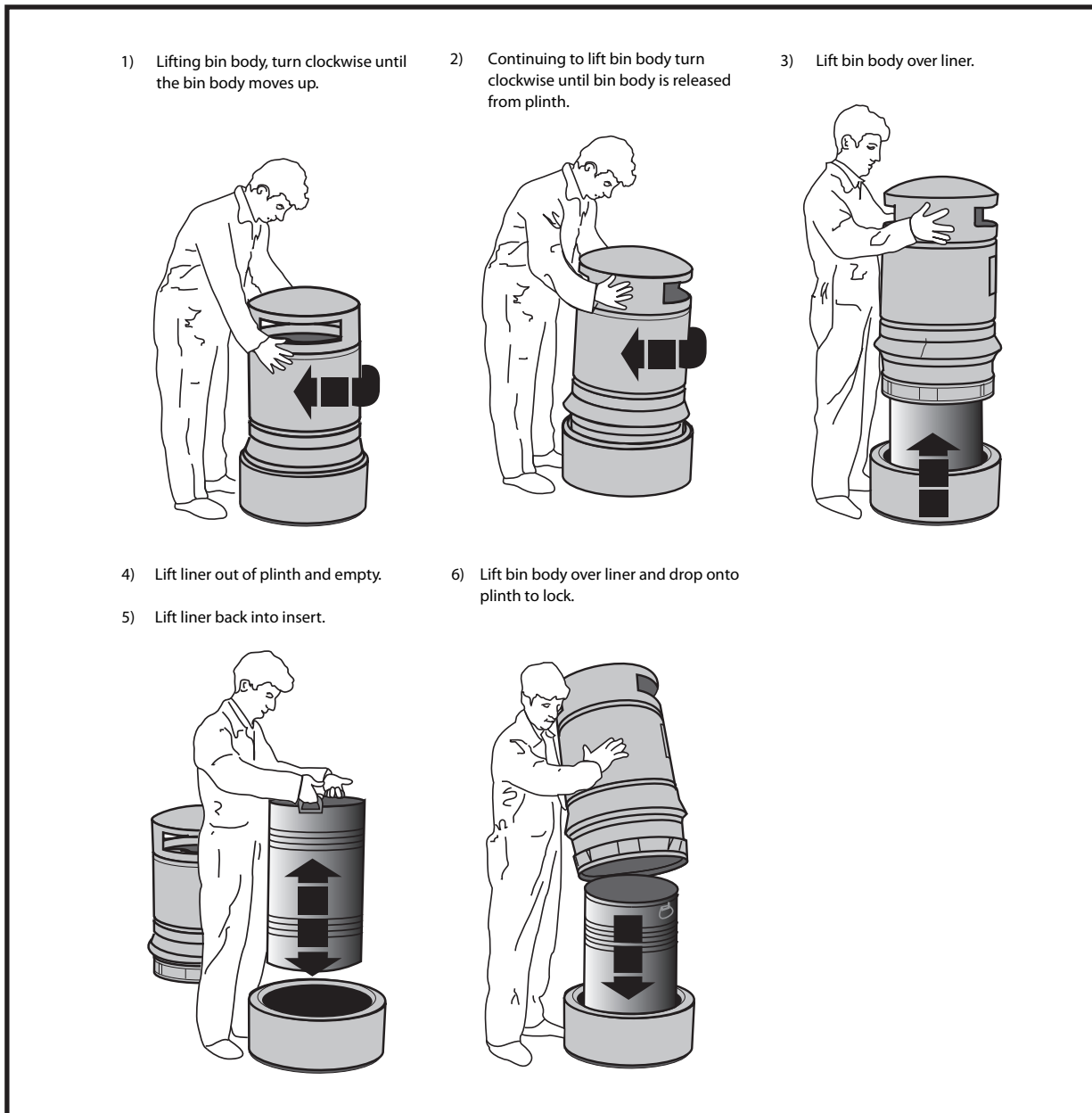

### Fixing

- For concrete fixing ensure 210mm plate is used.
- For paving slabs fixing use standard washers and bolts.

### Maintenance

Clean with warm soapy water.

 Glasdon® AND MINI PLAZA™ ARE TRADEMARKS OR REGISTERED TRADEMARKS OF GLASDON GROUP OR ITS SUBSIDIARIES IN THE U.K. AND OTHER COUNTRIES

- A planned maintenance schedule of regular inspection is recommended, replacing components as necessary.
- Replacement components are available direct from GLASDON.
- GLASDON cannot be held responsible for claims arising from incorrect installation, unauthorised modifications or misuse of the product.

Issue 4 March 2005 Stock no. C000/0147

© Copyright March 2005. Glasdon reserve the right to alter specification without prior notice.



### Glasdon U.K. Limited

Preston New Road  
BLACKPOOL  
Lancashire  
FY4 4UL

Tel: (01253) 600410

Fax: (01253) 792558

e-mail: sales@glasdon-uk.co.uk

web:www.glasdon.com